

PARTS LIST:

Qty	Description
2	Universal LED "L" Mounting Brackets
2	10-1.5mm x 25mm Hex Bolts
4	10mm x 24mm OD x 2.2mm Flat Washers
2	10-1.5mm Nylon Lock Nuts
2	6mm x 22mm OD x 2.2mm Flat Washers
2	8mm x 22mm OD x 2mm Flat Washers
2	10mm x 24mm OD x 2.2mm Flat Washers

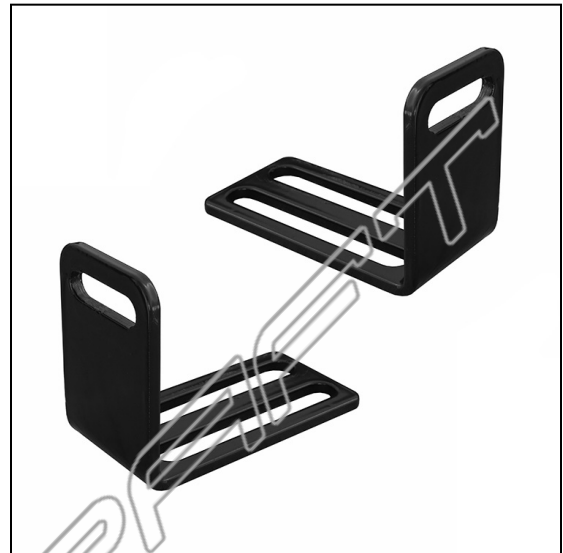

REMOVE CONTENTS FROM BOX. VERIFY ALL PARTS ARE PRESENT. READ INSTRUCTIONS CAREFULLY BEFORE STARTING INSTALLATION. LED BRACKETS ARE DESIGNED TO ALLOW INSTALLATION OF MOST POPULAR LED "BAR STYLE" LIGHTS WITH HOUSING DIMENSIONS OF 8" TO 24" ONLY.

IMPORTANT: Sizes of LED lights and traditional round, square or rectangular lights can vary greatly. Verify all dimensions before purchasing or installing aftermarket lights.

PROCEDURE:

- 1) Starting at the driver side of the 3-1/2" Bull Bar, remove the Light Bracket from the Bull Bar if installed, **(Figure 1)**.
- 2) Select (1) LED "L" Bracket. Note the (2) slots in the bottom leg of the "L" Bracket to allow for front to back adjustment. Bolt the "L" Bracket to the top of the Light Bracket with (1) 10mm Hex Bolt, (2) 10mm Flat Washers and (1) 10mm Nylon Lock Nut, **(Figure 2)**. Do not tighten 10mm hardware at this time.
- 3) Repeat **Steps 1 & 2** to attach the second "L" Bracket to the remaining Light Bracket. Reuse the (4) Button Head Screws, (4) Lock Washers and (4) Flat Washers to attach the Bracket assemblies to the Bull Bar. **NOTE:** Light Brackets and hardware are supplied with the 3-1/2" Bull Bar hardware kit only.
- 4) Select the best procedure for your particular installation and size of LED light:
 - a) LED lights with an overall width, (light housing only), of 10" (256mm) — 16" (408mm) will install with the "L" Brackets facing "in" and may have room remaining for traditional round or rectangular lights to the outside if desired, **(Figure 3)**.
 - IMPORTANT:** If installing additional lights to the outside of the LED light bar, use the bolt/stud on the bottom of the light to attach the "L" Bracket to the Bull Bar Light Bracket, **(Figure 4)**.
 - b) LED lights with an overall width, (light housing only), of 18.9" (481mm) — 24.9" (633mm) will install brackets facing "out" with no room for additional lights, **(Figure 3)**.
- 5) Remove the factory brackets bolted to the ends of the LED light, (light not included). Slide the "L" Brackets out of the way of the LED light. Reuse the hardware from the light to attach the LED light to the (2) "L" Brackets. **NOTE:** Depending on the LED light manufacturer and hardware used, larger flat washers may be required to cover the slot in the "L" Bracket and have been included. Select the appropriate 6mm, 8mm or 10mm Flat Washers from the "L" Bracket hardware package.
- 6) Check for clearance between the LED light housing and the front bumper. If necessary, remove the LED light and "L" Brackets. Move the (2) 10mm Hex Bolts from the forward slots in the brackets to the rear slots to move the LED light forward slightly if desired, **(Figure 2)**. Once all adjustments have been made and the light properly adjusted, tighten all hardware. Follow the light manufacturer's installation instructions for proper electrical wiring to the vehicle.
- 7) Do periodic inspections to the installation to make sure that all hardware is secure and tight.

To protect your investment, wax this product after installing. Regular waxing is recommended to add a protective layer over the finish. Do not use any type of polish or wax that may contain abrasives that could damage the finish. Use mild soap to clean the "L" Brackets.

Examples of typical LED "L" Bracket installation

Remove Button head screws to remove Light Bracket

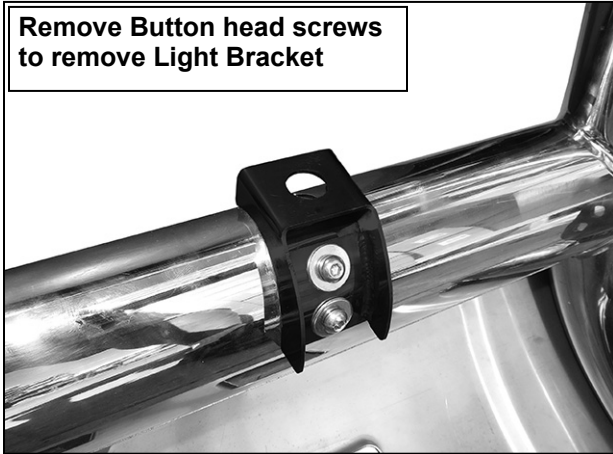

(Fig 1) 3-1/2" Bull Bar Light Bracket pictured (not included with the "L" Bracket kit)

10" (256mm) — 16" (408mm)

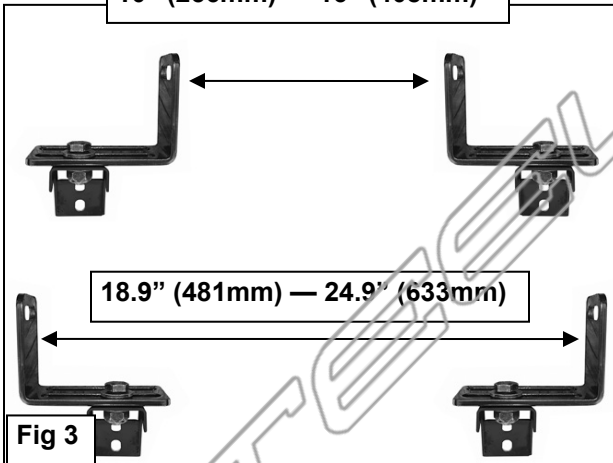
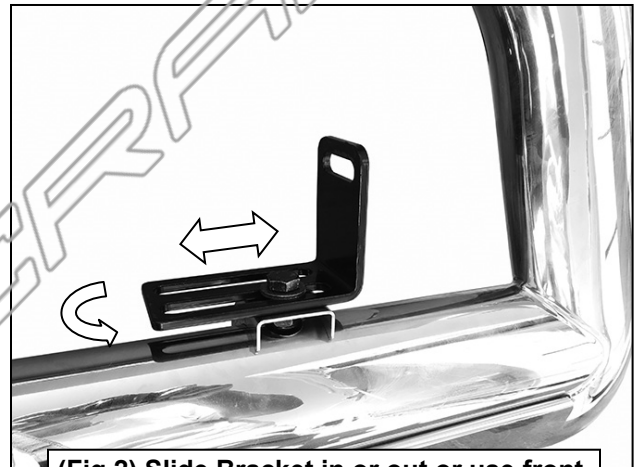

Fig 3

Complete Installation
(light not included)



(Fig 2) Slide Bracket in or out or use front or rear slot as necessary for proper fit

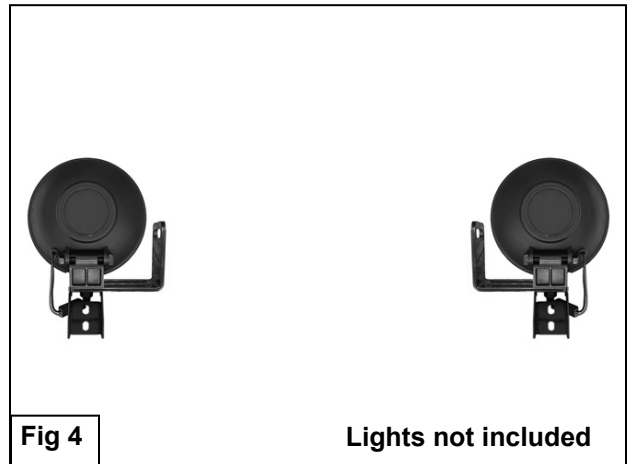

Fig 4

Lights not included