

STEELCRAFT EXTREME HEAVY DUTY GRILLE GUARD 2015-25 FORD E-SERIES

PARTS LIST:

1	Extreme HD Grille Guard	2	12mm Fish Wire
1	Driver/Left Frame Support Bracket	4	12mm Plastic Retainers
1	Passenger/Right Frame Support Bracket	4	12-1.75mm x 50mm Bolt Plates
1	Driver/Left Frame Bracket	6	12-1.75mm x 40mm Hex Bolts
1	Passenger/Right Frame Bracket	16	12mm x 32mm x 3mm Flat Washers
1	Driver/Left Top Support Bracket	10	12mm Nylon Lock Nuts
1	Passenger/Right Top Support Bracket	2	8 -1.25mm x 35mm Hex Bolts
2	10-1.5mm x 40mm Hex Bolts	2	8mm Lock Washers
4	10mm x 27mm x 3mm Flat Washers	2	8mm x 24mm x 2mm Flat Washers
2	10mm Nylon Lock Nuts	2	Foam Pads

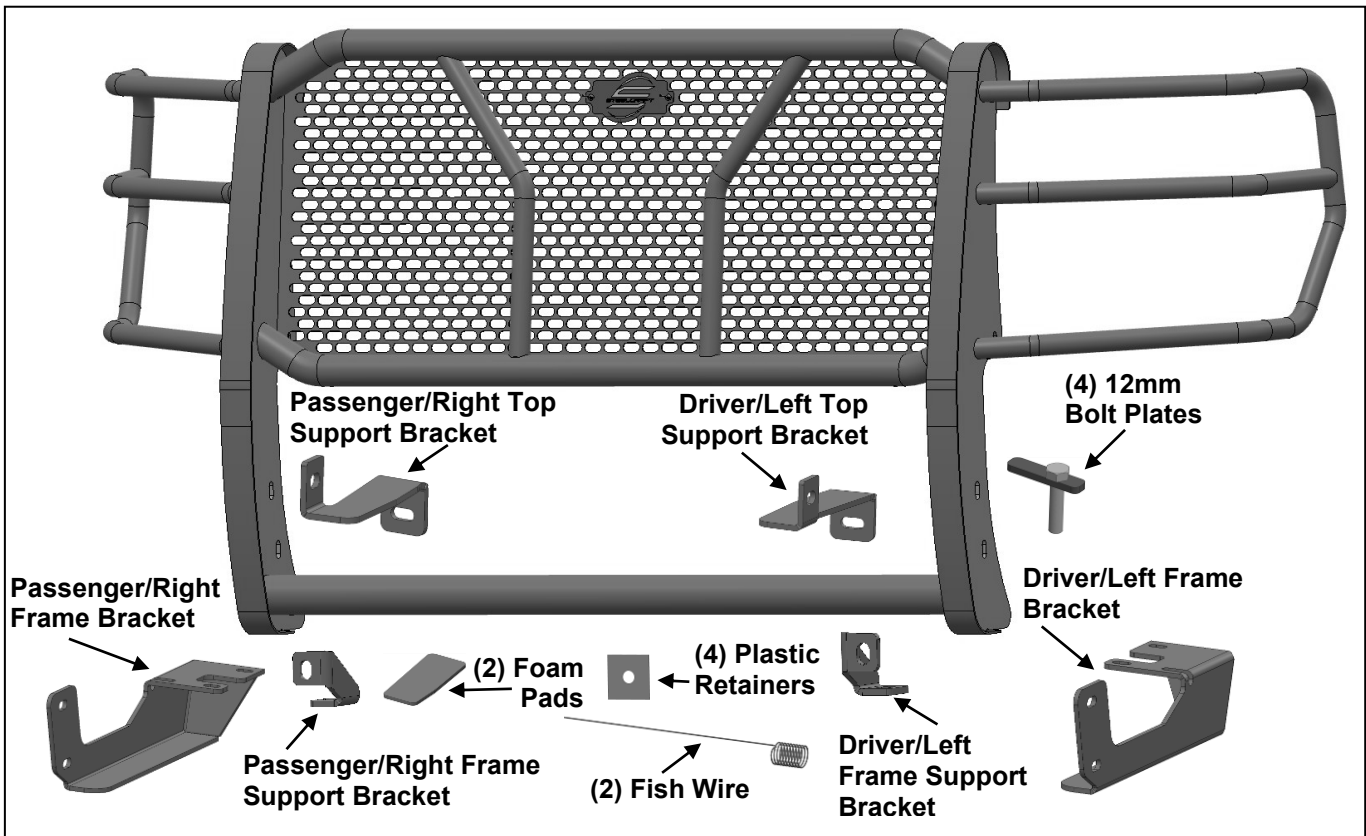

PROCEDURE:

REMOVE CONTENTS FROM PACKAGING AND VERIFY ALL PARTS ARE PRESENT. SOME SMALL PARTS WILL BE HIDDEN IN WRAPPINGS. READ INSTRUCTIONS CAREFULLY. MINOR TRIMMING AND DRILLING MAY BE REQUIRED. INSTALLATION MAY INTERFERE WITH FRONT MOUNTED SENSORS. REMOVE RUBBER STRIPS FROM UPRIGHTS AFTER INSTALLATION IS COMPLETE.

1. From underneath the vehicle, locate the air scoop and remove it completely, **(Figure 1)**.
2. Starting on the driver/left side, carefully remove the plastic clip securing the plastic air dam, then move the panel off to the side. Be sure it is positioned so that it does not interfere with access to the bottom of the frame during the following steps, **(Figure 1 & 2)**.
3. Locate the existing factory hole in the frame, **(Figure 2)**. Using a 1/2-inch drill bit, carefully enlarge this hole to the proper size. Make sure the drill is kept level and steady during this process to avoid damaging the surrounding metal. Wear safety goggles during this step to protect your eyes from metal shavings.
4. Prepare the Bolt Plate for installation by attaching the provided Fish Wire. Insert the threaded end of the Bolt Plate through the loop on the Fish Wire and twist it securely until it is fastened in place, **(Figure 3)**. Ensure the fish wire is tightly wound so the bolt plate does not slip off.

STEELCRAFT EXTREME HEAVY DUTY GRILLE GUARD
2015-25 FORD E-SERIES

5. Insert the Fish Wire through the access slot in the frame and guide it through until the Fish Wire end exits the hole that you drilled out previously, **(Figure 4)**. Once the wire is through, carefully pull on it to draw the bolt plate into the frame and out through the drilled hole, **(Figure 5)**.
6. Insert the second Bolt Plate into the access slot in the frame by hand. Maneuver the bolt plate carefully through the opening until the threaded end is positioned correctly through the frame, **(Figure 6)**.
7. Once both Bolt Plates are in position, secure them by threading the supplied Plastic Retainers onto the threaded ends. Tighten the retainers until they hold the Bolt Plates firmly in place and prevent them from sliding back into the frame, **(Figure 7)**.
8. Repeat **Steps 2-7** to the passenger/right side.
9. Locate the factory bumper openings where the Frame Brackets will pass through. Using a cutting tool, carefully trim the edges of the opening as needed to create enough clearance for the Frame Bracket. Take your time to ensure the cut is clean and only remove as much material as necessary for proper fitment, **(Figure 8)**.
10. Select the driver/left side Frame Bracket and slide it through the bumper opening. Place Frame Bracket through the previously installed Bolt Plates. Secure to Bolt Plates using (2) 12mm Flat Washers and (2) 12mm Nylon Lock Nuts, **(Figures 9 & 10)**. Do not fully tighten hardware at this time to allow for any necessary adjustments before final tightening.
11. Remove the OE nut from the end of the frame. Position the Frame Support Bracket into place and secure it re-using the OE nut along with (1) 12mm Hex Bolt, (2) 12mm Flat Washers, and (1) 12mm Nylon Lock Nut, **(Figure 11)**. Do not fully tighten hardware at this time.
12. Repeat **Steps 10-11** for the passenger/right side Frame Bracket and Frame Support Bracket installation.
13. Take the provided Foam Pads and apply them to the bottom surface of both Top Support Brackets. Press firmly to ensure the pad adheres securely and provides proper cushioning when the bracket is installed, **(Figure 12)**.
14. Take the Driver/Left Top Support Bracket and carefully slide it into position by starting at the wheel well, between the bumper and the fascia. Make sure the Foam Pad installed in the previous step is facing downward against the bumper to prevent scratching or damage during installation, **(Figure 13)**.
15. Locate the OE bolt positioned behind the bumper and above the frame rail and remove the bolt, **(Figure 14)**.
16. Attach the Top Support Bracket to the bumper using (1) 8mm x 35mm Hex Bolt, (1) 8mm Flat Washer, and (1) 8mm Lock Washer, **(Figure 15)**. Do not fully tighten hardware at this time.
17. Repeat **Steps 14-16** to passenger/right side.
18. **Optional:** Reattach the Plastic Air Dam by securing it to the front-most Bolt Plate. If necessary, use the Nylon Lock Nut and Washer to hold the panel in place, **(Figure 16)**. Do not fully tighten hardware at this time.
19. Carefully unwrap the Grille Guard.
20. With assistance, hold the Grille Guard up to the outside of the Frame Brackets. Attach the Grille Guard to the Frame Brackets with the included (4) 12mm x 40mm Hex Bolts, (8) 12mm Flat Washers, and (4) 12mm Nylon Lock Nuts, **(Figure 17 & 18)**. Do not fully tighten hardware.
21. Attach the outer end of the driver/left Top Support Bracket to the inside of the Grille Guard upright with the included (1) 10mm x 40mm Hex Bolt, (2) 10mm Flat Washers and (1) 10mm Nylon Lock Nut, **(Figure 19 & 20)**. Repeat this **Step** to attach the passenger/right Top Support Bracket to the Grille Guard.
22. Level and adjust the Grille Guard properly and fully tighten all hardware including the Frame Support Bracket hardware.
23. Do periodic inspections of the installation to make sure that all hardware is secure and tight.

To protect your investment, wax this product after installing. Regular waxing is recommended to add a protective layer over the finish. Do not use any type of polish or wax that may contain abrasives that could damage the finish. Mild soap may be used to clean the Grille Guard.

Driver/left Side Installation Pictured

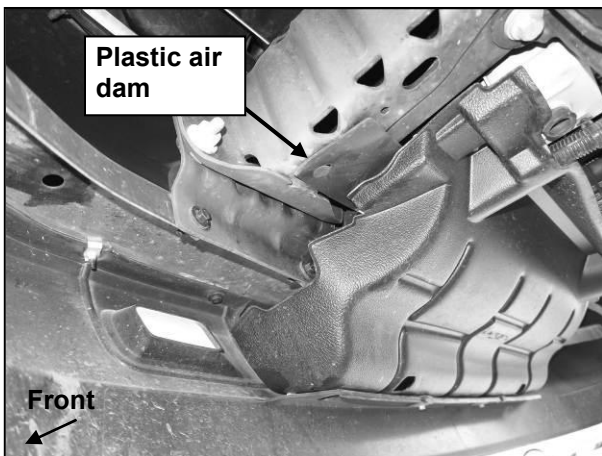

(Fig 1) Remove air scoop and plastic air dam covering the bottom of the frame

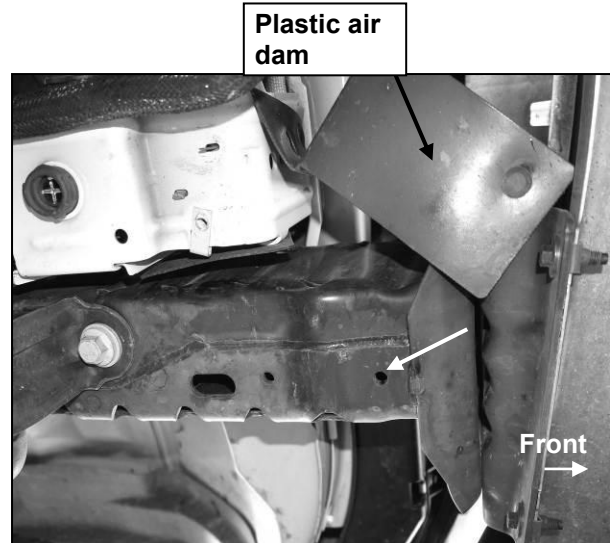

(Fig 2) Drill out existing hole to 1/2" diameter

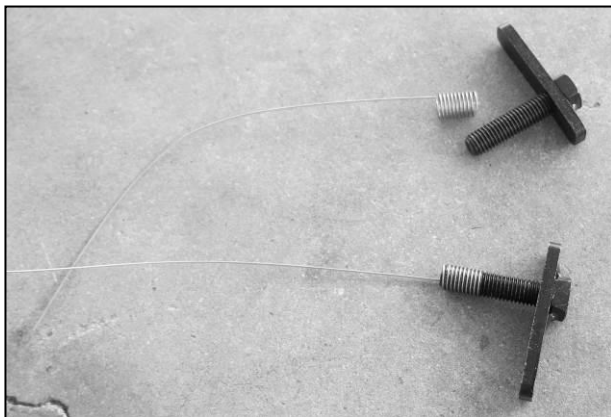

(Fig 3) Twist Fish Wire onto Bolt Plate



(Fig 5) Pull Bolt Plate fully through frame

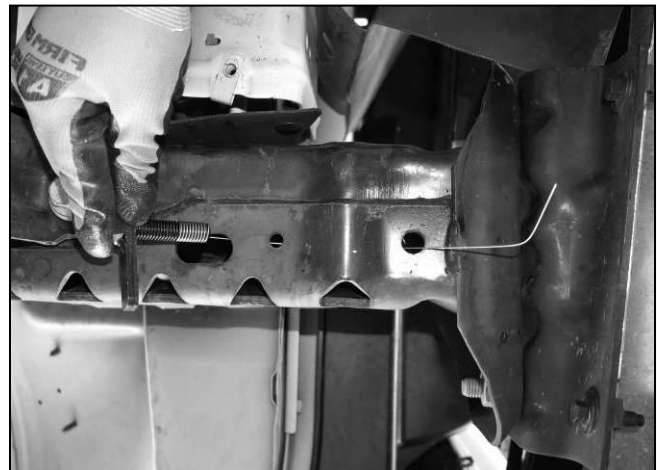

(Fig 4) Insert Fish Wire through the frame slot and out previously drilled hole

Driver/left Side Installation Pictured

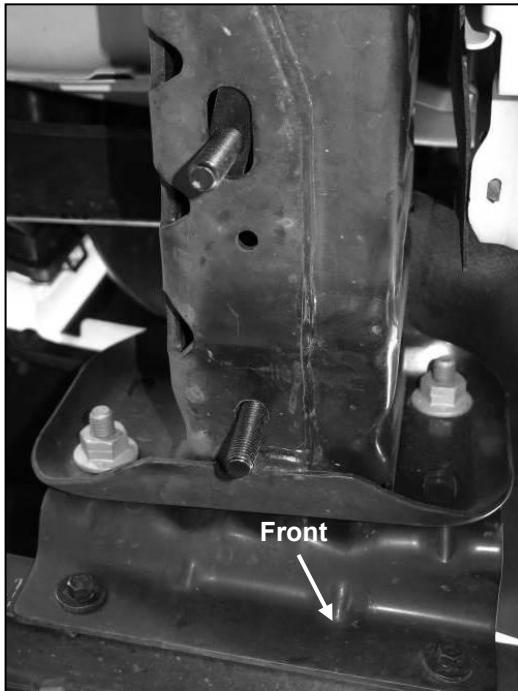

(Fig 6) Insert second Bolt Plate through slot in the frame

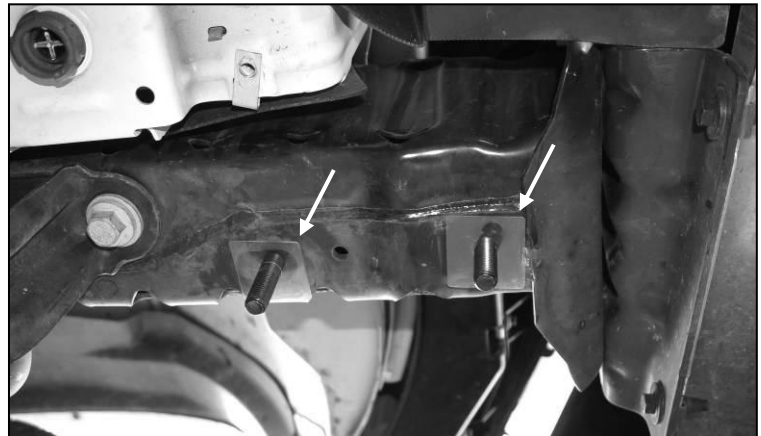

(Fig 7) Thread Plastic Retainers on to studs to hold Bolt Plates in place

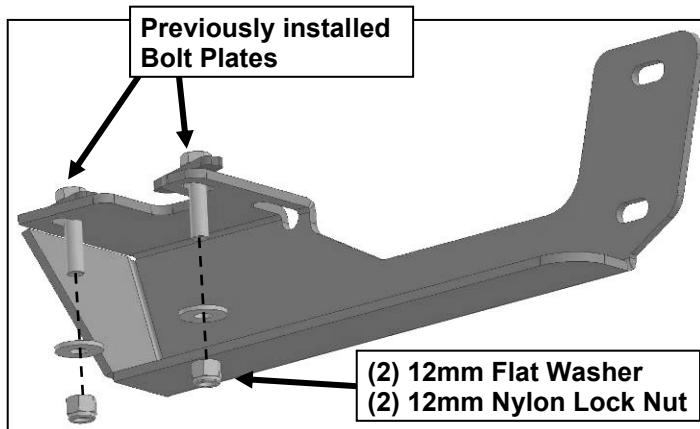

(Fig 9) Attach Driver/Left side Frame Bracket



(Fig 8) Hold Frame Bracket up to opening and trim to clear as necessary



(Fig 10) Driver/Left side Frame Bracket installed.

Driver/left Side Installation Pictured

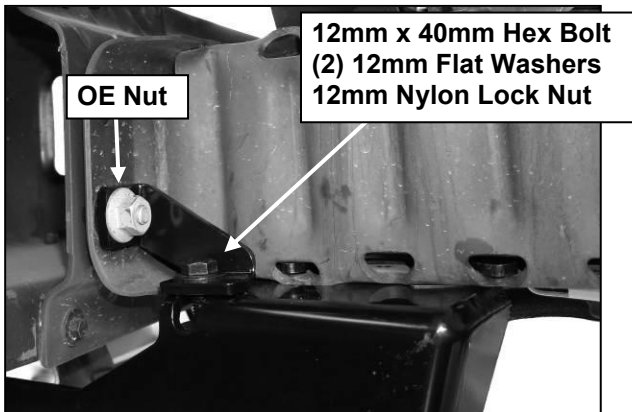

(Fig 11) Remove OE nut and attach Frame Support Bracket

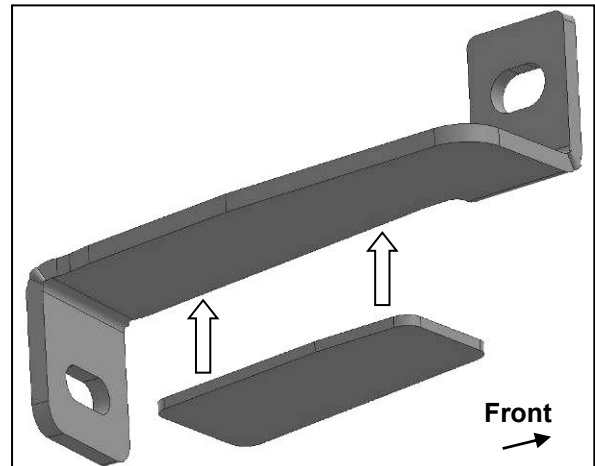

(Fig 12) Stick Foam Pad to the bottom of the Top Support Brackets



(Fig 13) Starting at the wheel well, slide Top Support bracket between bumper and fascia.

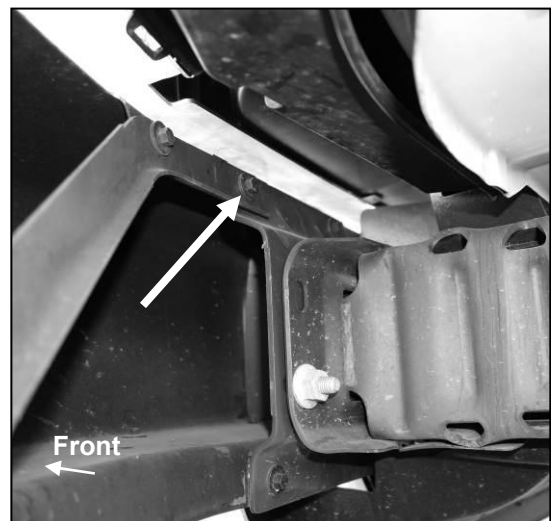

(Fig 14) Remove OE Bolt

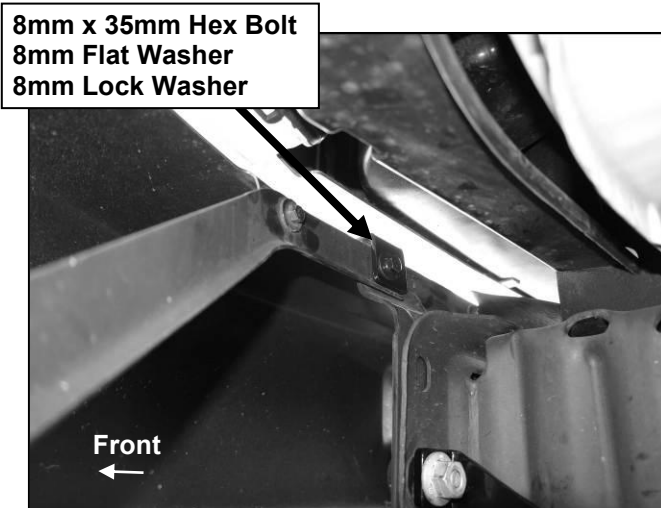

(Fig 15) Attach Support Bracket to bumper



(Fig 16) OPTIONAL: Re-attach plastic air dam to Bolt by sliding over stud

**STEELCRAFT EXTREME HEAVY DUTY GRILLE GUARD
2015-25 FORD E-SERIES**

Driver/left Side Installation Pictured

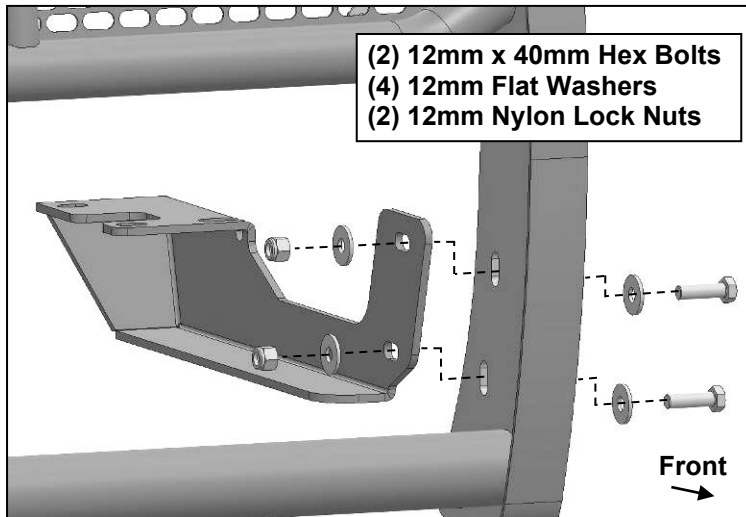

(Fig 17) Attach Driver/Left Frame Bracket to the Grille Guard

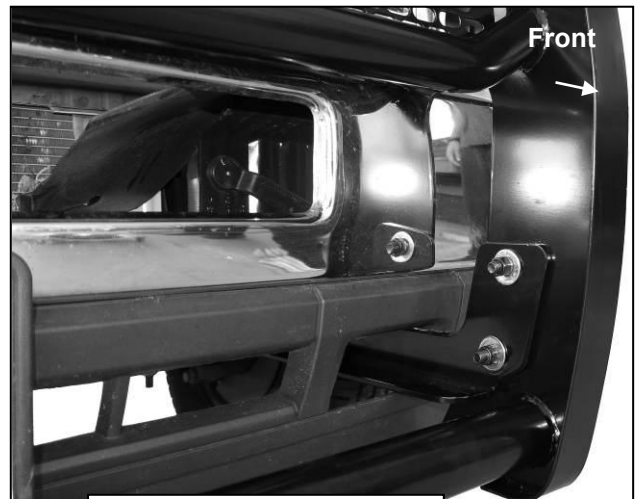

(Fig 18) Driver/Left Frame Bracket installed

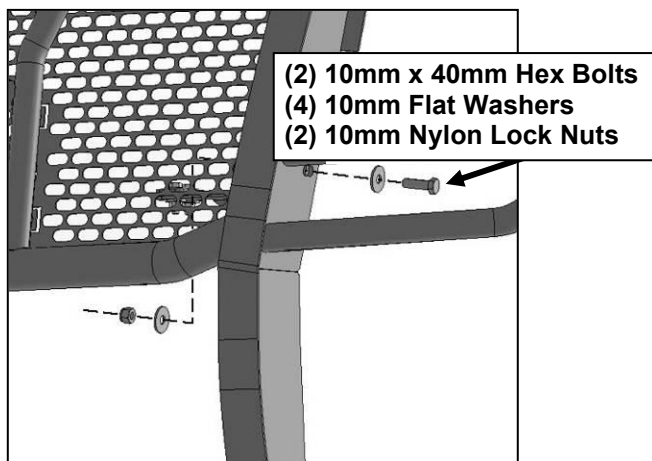

(Fig 19) Attach Driver/Left Top Support Bracket to inside of Grille Guard upright



(Fig 20) Driver/Left Top Support Bracket installed



Completed Installation